

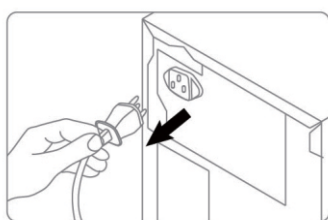

# SSD Installation Guide for Desktops

## Step 1.

Before the installation commences, be sure to shut down your Computer by disconnecting the power cord and remove any battery if so equipped.

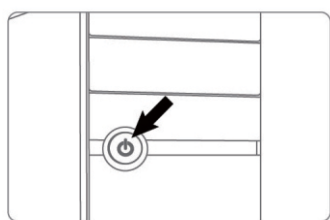

## Step 2.

Remove the computer casing of your computer (Please refer to your computers owners manual). Locate and identify the SATA connectors of your system. Please refer to your user manual if you choose to remove the existing drive.

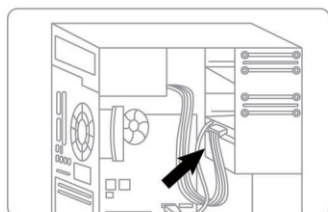
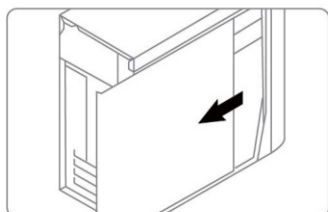

## Step 3.

SATA cables attached to the computers motherboard should be connected to the SATA data and SATA power connectors on the SSD drive. Please be aware that the "L" shaped connector will only fit in one direction. Before connecting be sure that the plugs are aligned properly.

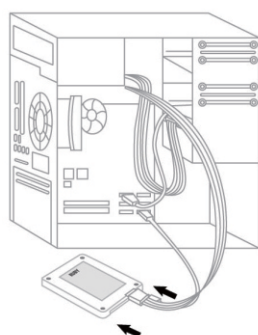
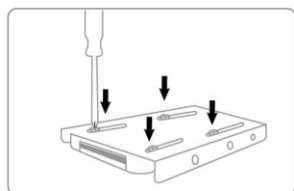
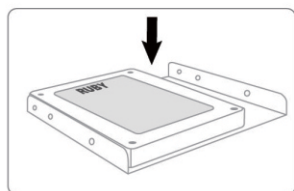

## Step 4.

The SSD can be securely mounted with the screws provided as seen below.

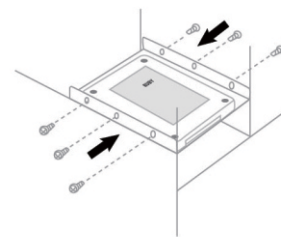
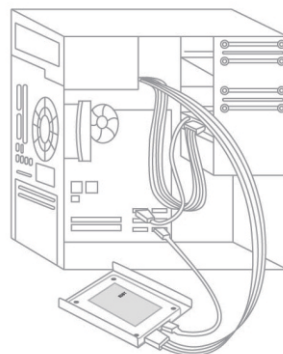

## Step 5.

After the installation is completed, restore power to the computer. (Power or Battery)

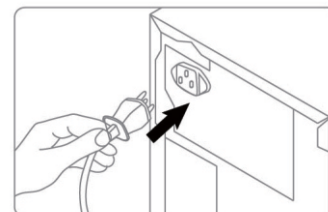
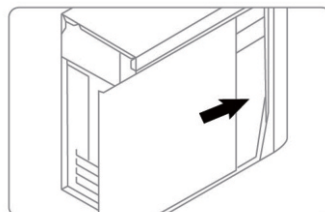

## Step 6.

Switch the Computer on for installation verification.

